

# TIPPERARY COUNTY COUNCIL

## **NENAGH TRAFFIC MANAGEMENT PLAN - ONE WAY SYSTEM** **Pearse St (R497), Mitchel St (R873), Emmet Place (L1241),** **Kickham St (R445) and Silver St (R497), Nenagh**

### **Section 38 of the Road Traffic Act, 1994**

#### DRAWINGS

- |               |   |  |
|---------------|---|--|
| 21057-01-0022 | - | SITE LOCATION MAP  |
| 21057-01-0021 | - | GENERAL LAYOUT   |
| 21057-01-0006 | - | SIGNS AND ROADMARKINGS - OVERALL LAYOUT                                  |
| 21057-01-0007 | - | SIGNS AND ROAD MARKINGS - MITCHEL ST. / EMMET PLACE JUNCTION             |
| 21057-01-0008 | - | SIGNS AND ROAD MARKINGS - EMMET PLACE / BANBA SQ. / KICKHAM ST. JUNCTION |
| 21057-01-0009 | - | SIGNS AND ROAD MARKINGS - KICKHAM ST. / PEARSE ST. JUNCTION              |
| 21057-01-0010 | - | SIGNS AND ROAD MARKINGS - SILVER ST. / MITCHEL ST. JUNCTION              |

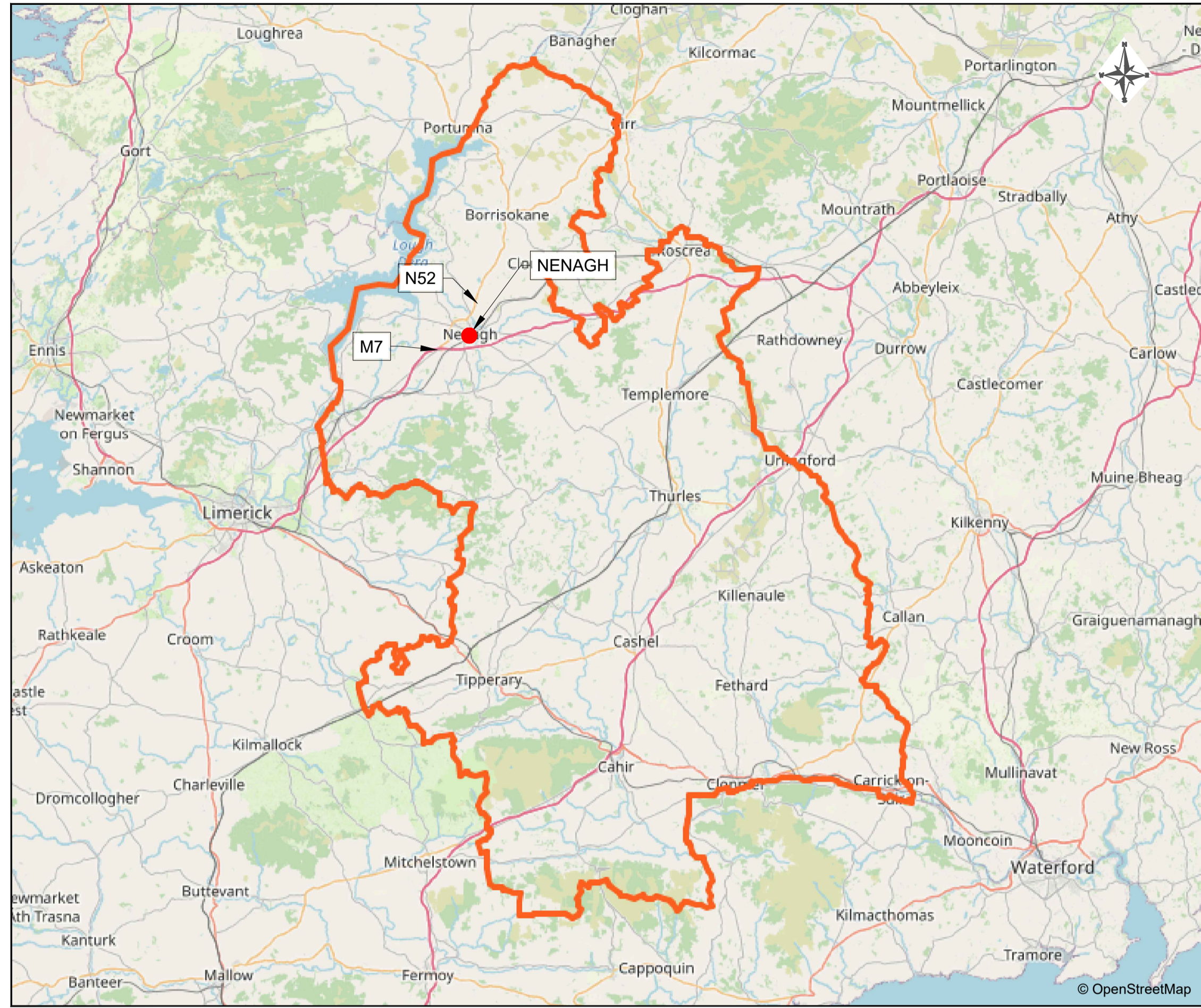

**COUNTY MAP**  
NTS

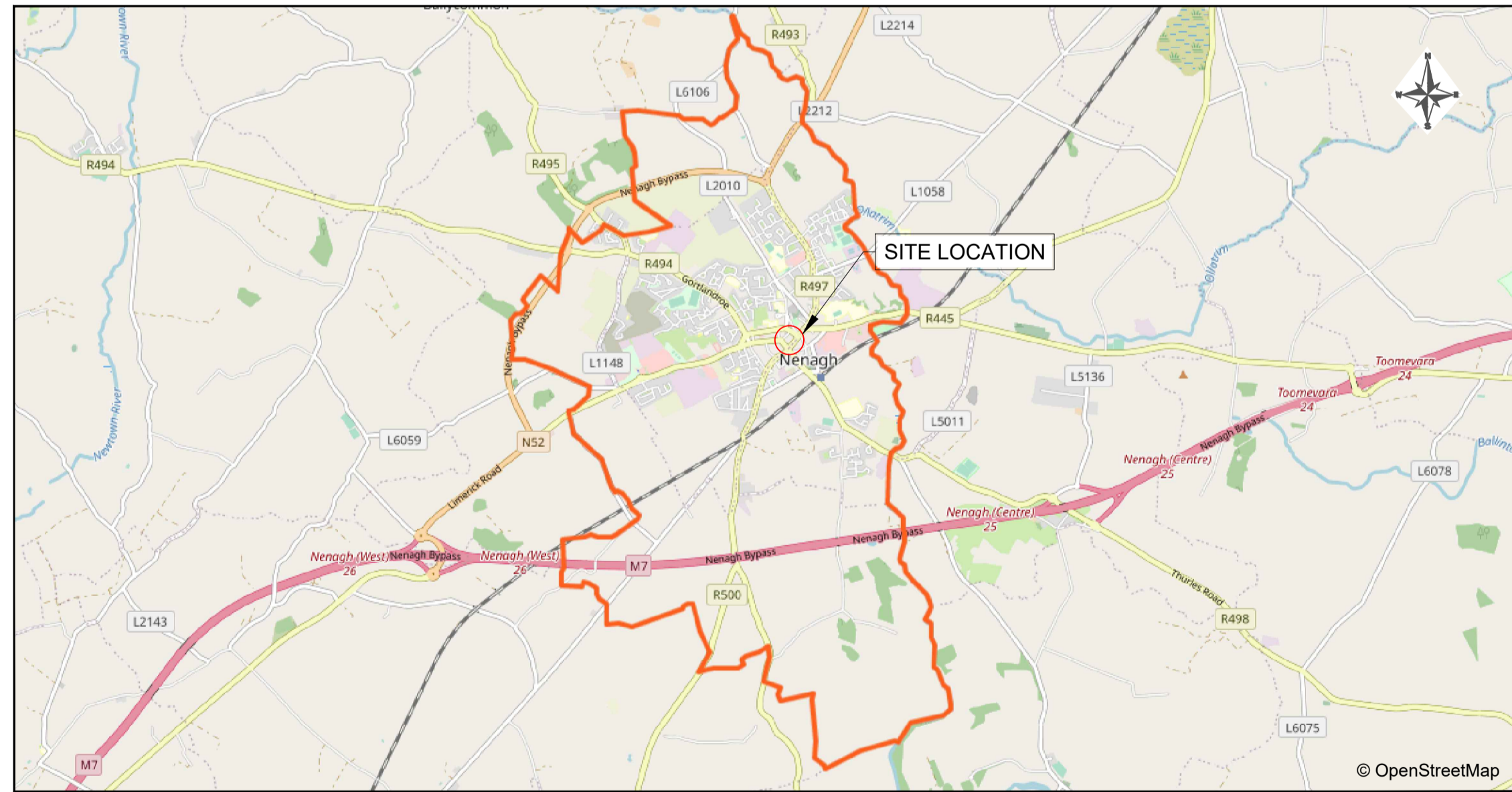

**TOWN MAP**  
NTS

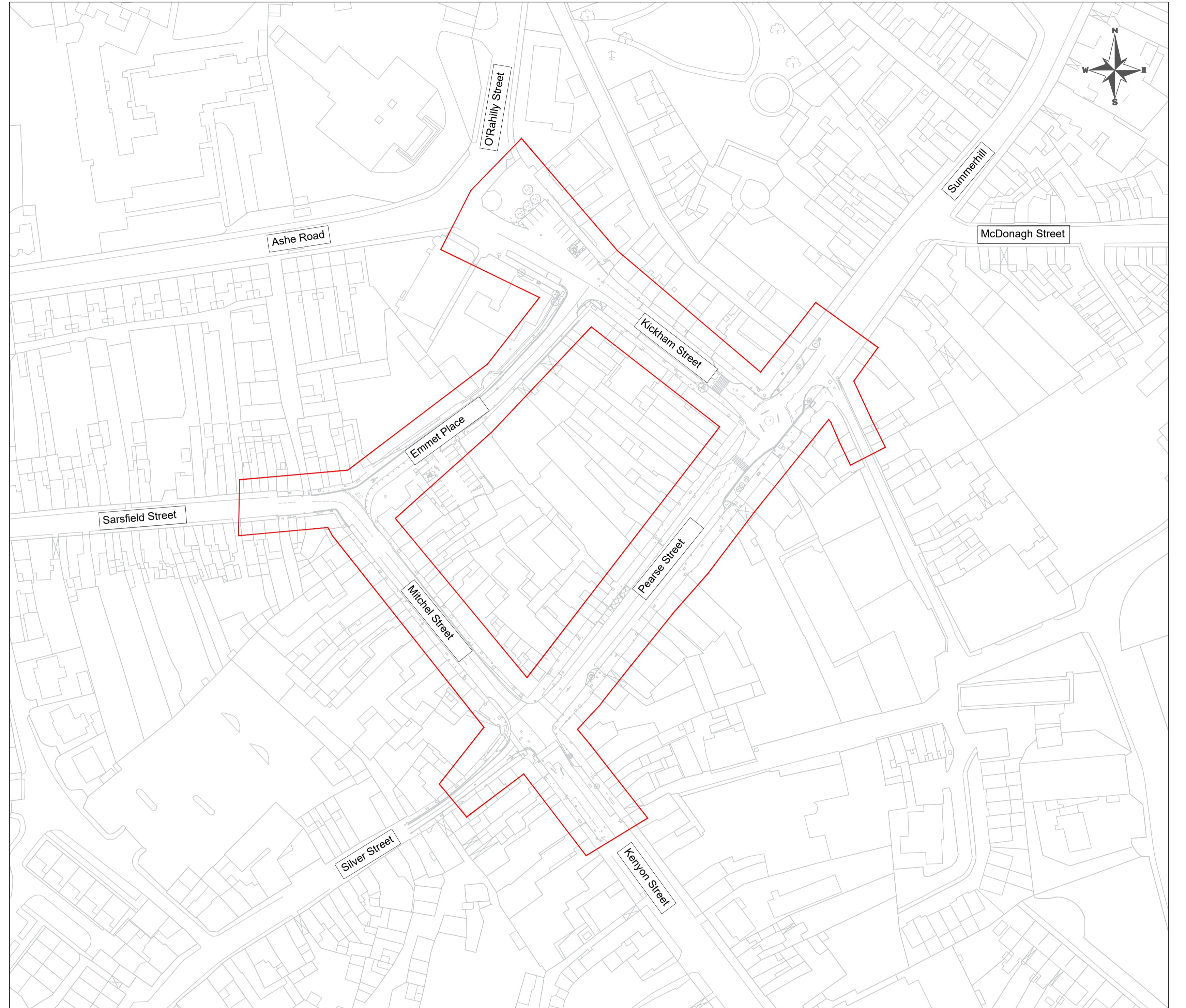

**LOCATION MAP**  
SCALE 1:2000

© Ordnance Survey Ireland. All rights reserved.  
Licence number 2021/06/CCMA/CorkCountyCouncil



Tionscadal Éireann  
Project Ireland  
**2040**



Tipperary County Council  
Civic Offices, Clonmel | Civic  
Offices, Nenagh,  
Co. Tipperary



7 Ormonde Road,  
Kilkenny  
Tel: +353(0)567795800  
e-mail: info@roadplan.ie

**LEGEND**

— SITE BOUNDARY

No.	Revision	Date	By	Chk'd	App'd

Project Title: <b>NENAGH TMP - ONE WAY SYSTEM</b>			
Drawing Title: <b>Site Location Map</b>			
Drawn by: <b>FH</b>	Sheet Size: <b>A1</b>	Scale: <b>As Shown</b>	Date: <b>Mar '23</b>
Drawing Number: <b>21057-01-0022</b>		Revision: <b>-</b>	

Designed: <b>AC</b>	Checked: <b>GF</b>	Approved: <b>DD</b>
------------------------	-----------------------	------------------------

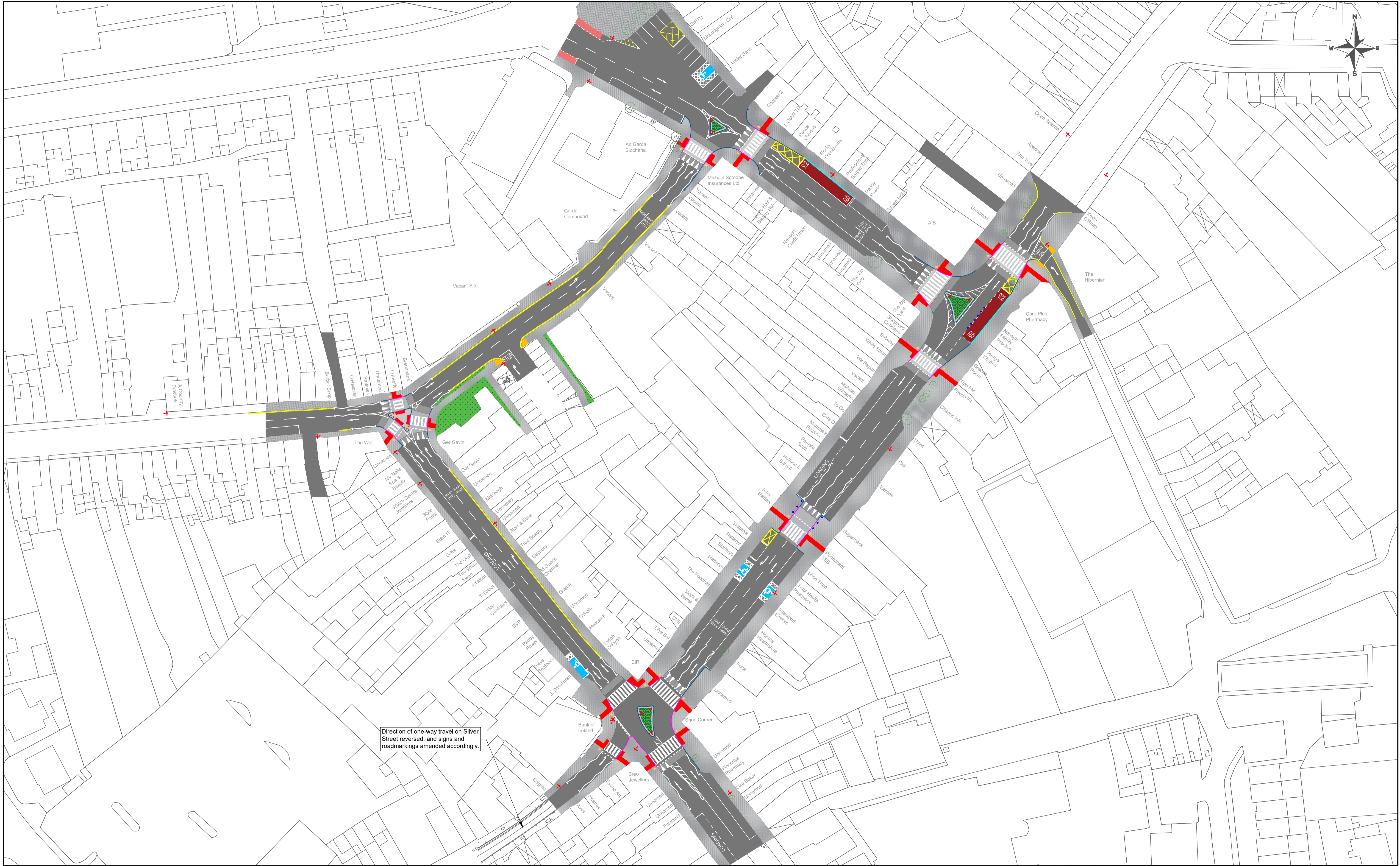
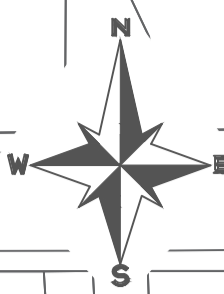

Direction of one-way travel on Silver Street reversed, and signs and roadmarkings amended accordingly.

Tipperary County Council  
Civic Offices, Clonmel | Civic  
Offices, Nenagh,  
Co. Tipperary



7 Ormonde Road,  
Kilkenny  
Tel: +353(0)567795800  
e-mail: info@roadplan.ie

LEGEND	
	Carriageway
	Ramp
	Raised table
	Central Island
	Footpath
	Tactile Pavement (Red)
	Tactile Pavement (Yellow)
	Cycle track
	Grass Verge
	Low Level Planting
	Bus Bay
	Bollards
	Belisha Beacon
	Trees
	Signage
	Existing Kerbline
	Proposed Transition Kerb
	Proposed Upstand Kerb
	Proposed Kassel Kerb

No.	Revision	Date	By	Chk'd	App'd
Designed:	AC	Checked:	GF	Approved:	DD

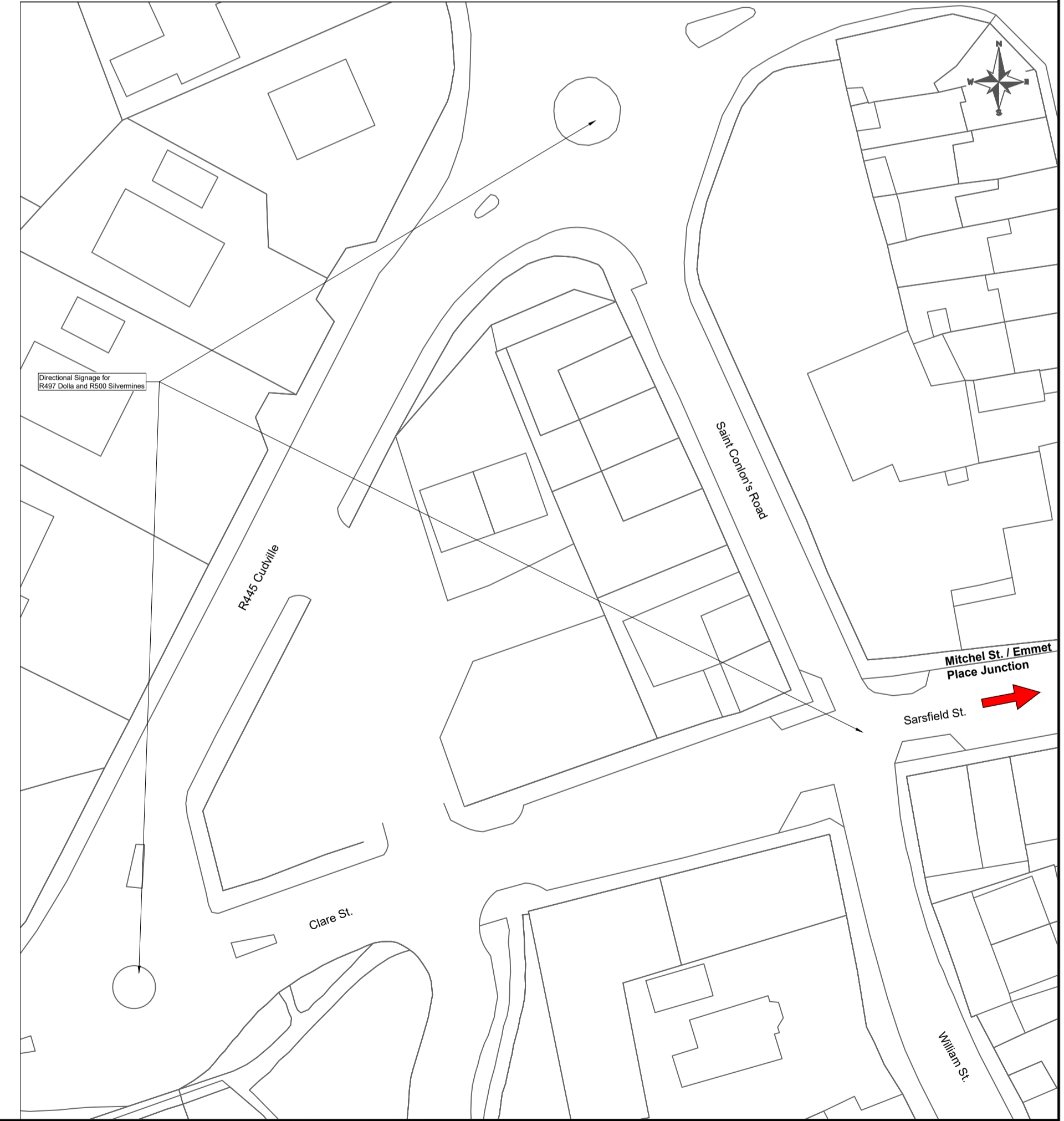
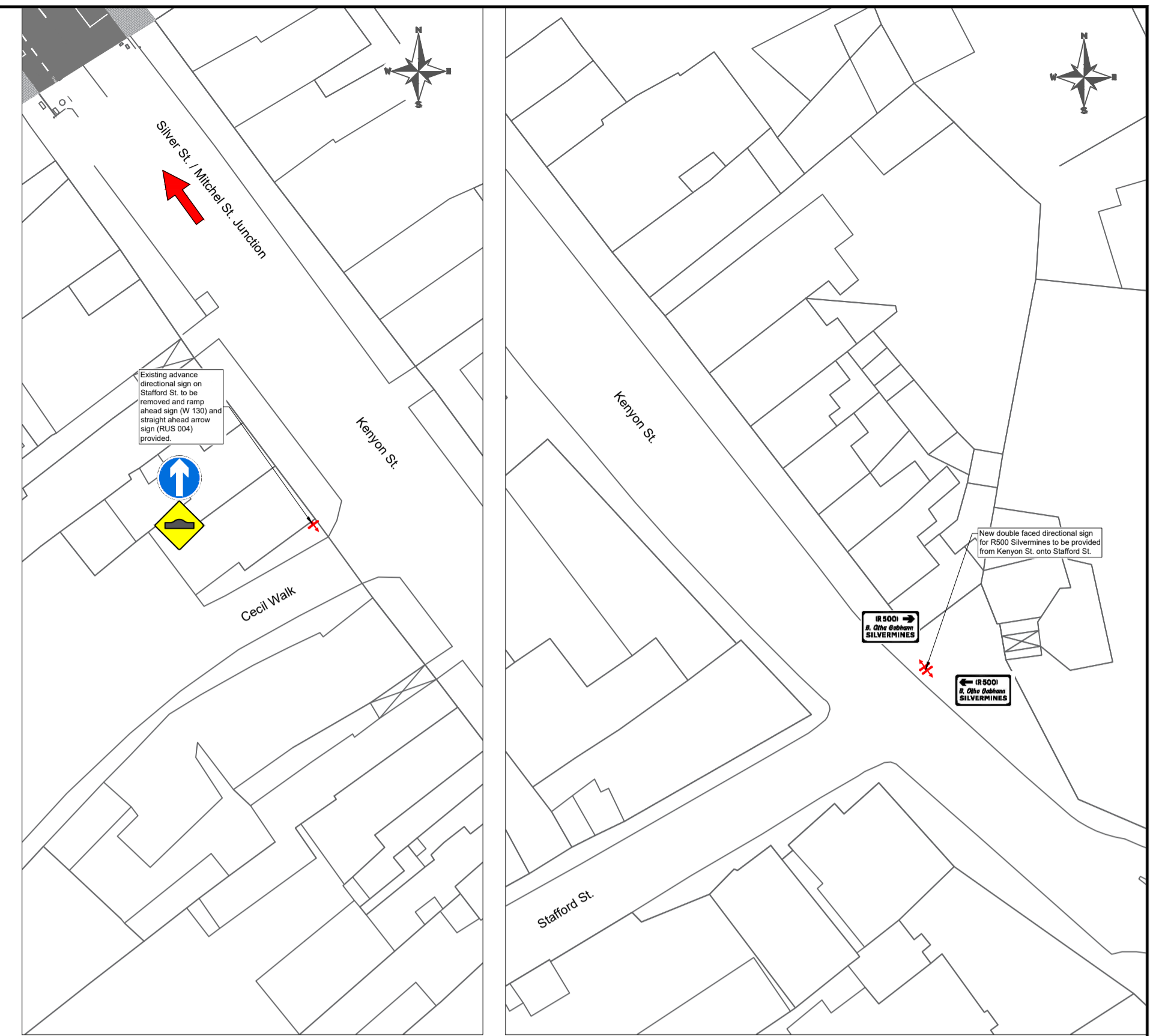
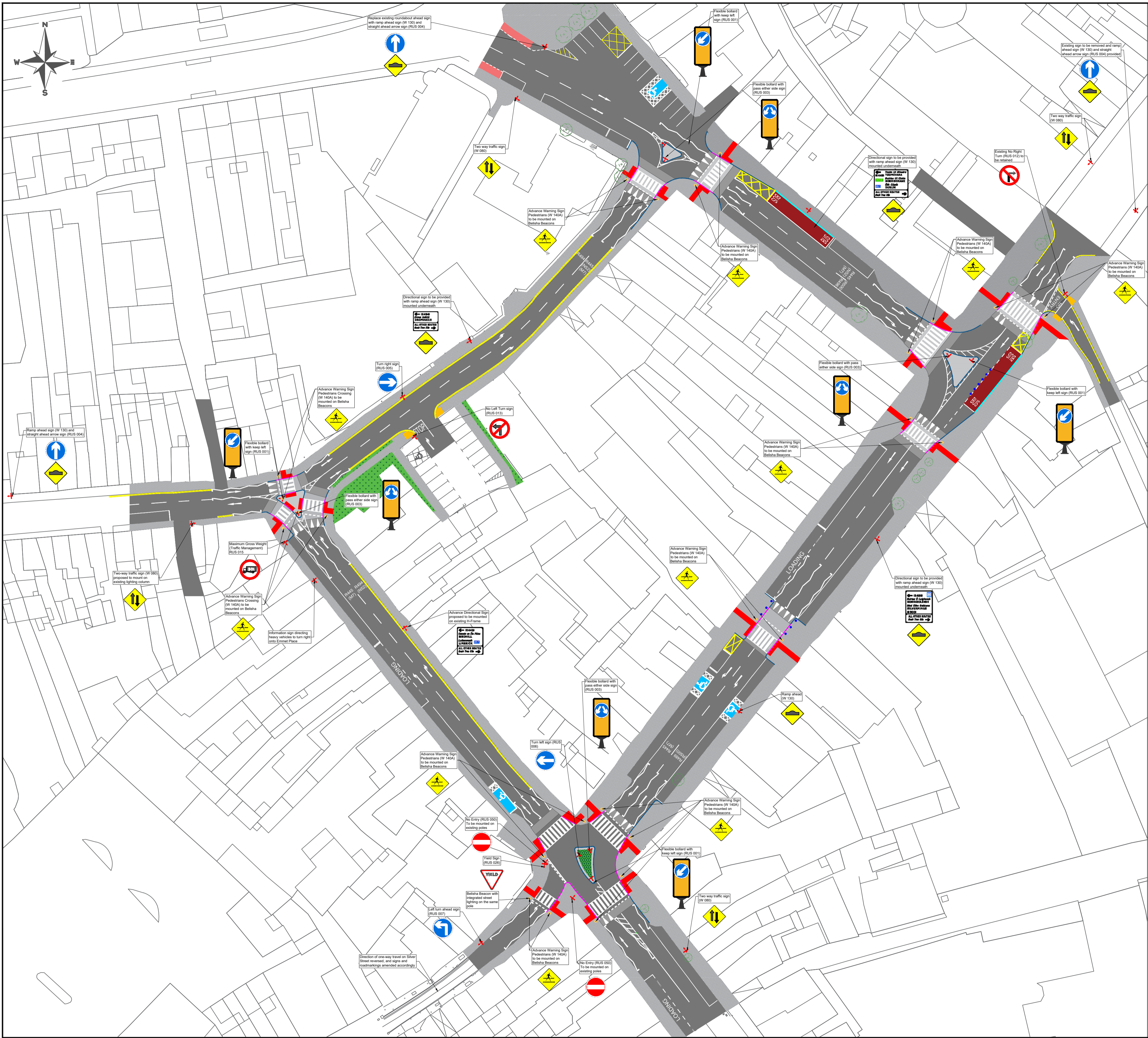
Project Title: <b>NENAGH TMP - ONE WAY SYSTEM</b>			
Drawing Title: <b>General Layout</b>			
Drawn by:	FH	Sheet Size:	A1
Scale:	1:500	Date:	Mar '23
Drawing Number:	21057-01-0021		Revision:
			-



Tipperary County Council  
 Civic Offices, Clonmel | Civic  
 Offices, Nenagh,  
 Co. Tipperary

7 Ormonde Road,  
 Kilkenny  
 Tel: +353(0)567795800  
 e-mail: info@roadplan.ie

**NOTES**

1. All signs to be provided with reflective sheeting (R151) unless otherwise specified.
2. All signs to be provided with reflective sheeting (R151) unless otherwise specified.
3. All signs to be provided with reflective sheeting (R151) unless otherwise specified.
4. All signs to be provided with reflective sheeting (R151) unless otherwise specified.
5. All signs to be provided with reflective sheeting (R151) unless otherwise specified.
6. All signs to be provided with reflective sheeting (R151) unless otherwise specified.
7. All signs to be provided with reflective sheeting (R151) unless otherwise specified.
8. All signs to be provided with reflective sheeting (R151) unless otherwise specified.
9. All signs to be provided with reflective sheeting (R151) unless otherwise specified.
10. All signs to be provided with reflective sheeting (R151) unless otherwise specified.

No.	Revision	Date	By	Chk'd	App'd
Designed:	AC	Checked:	GF	Approved:	DD

Project Title:  
**NENAGH TMP - ONE WAY SYSTEM**

Drawing Title:  
**Signs and Roadmarkings - Overall Layout**

Drawn by: FH    Sheet Size: A1    Scale: 1:500    Date: Mar '23

Drawing Number: 21057-01-0006    Revision: -

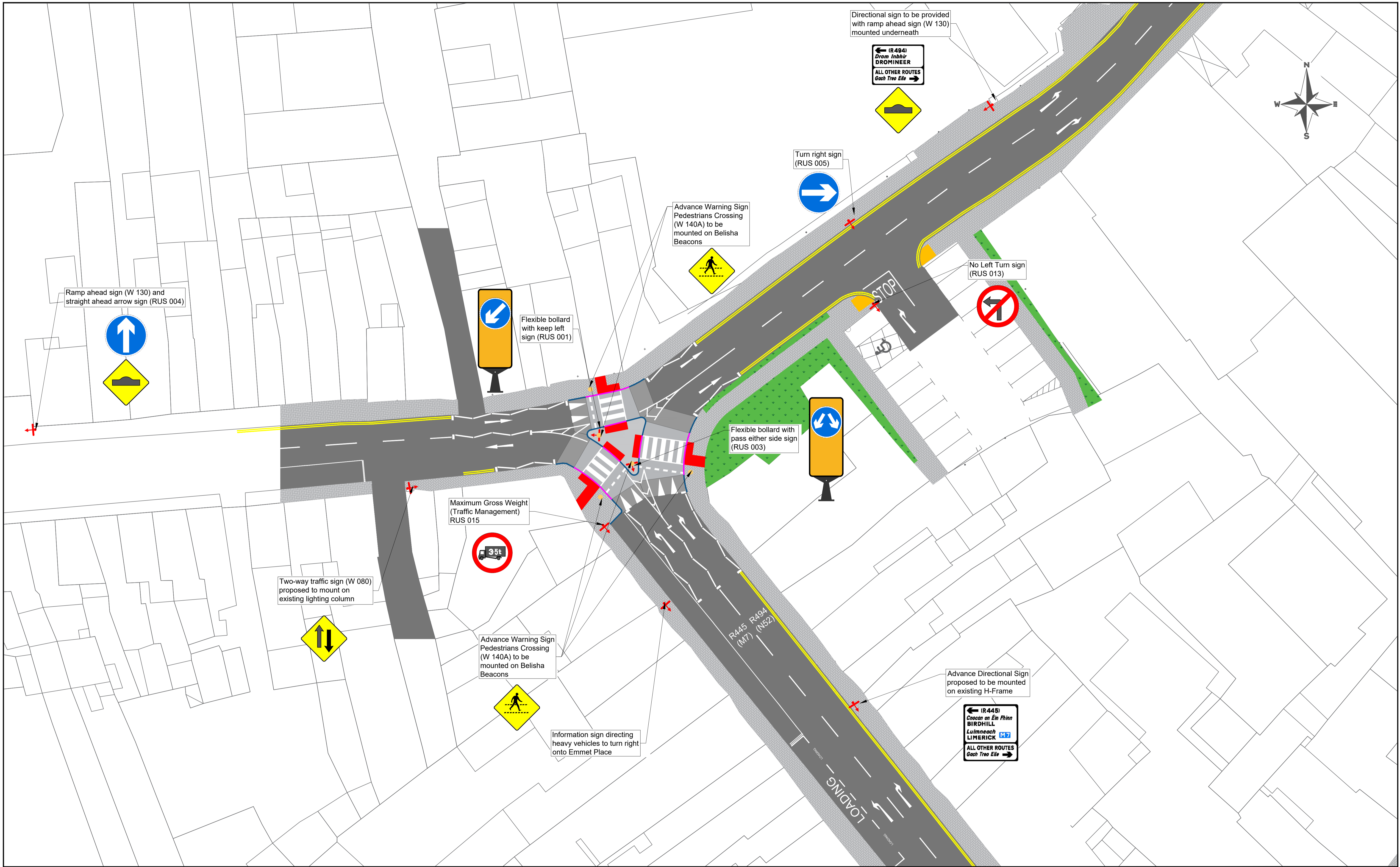

**NOTES**

- Raised table Zebra crossing introduced across all lanes at the junction, meeting at new central island
- Footpath built out at the western corner of the junction to provide greater turning radius and to define parking along the western side of Mitchell street

No.	Revision	Date	By	Chk'd	App'd
Designed:	AC	Checked:	GF	Approved:	DD

Replace existing roundabout ahead sign with ramp ahead sign (W 130) and straight ahead arrow sign (RUS 004)



Flexible bollard with keep left sign (RUS 001)

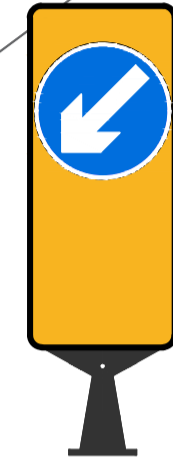

Flexible bollard with pass either side sign (RUS 003)



Two way traffic sign (W 080)

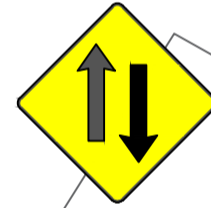

Advance Warning Sign Pedestrians (W 140A) to be mounted on Belisha Beacons



Advance Warning Sign Pedestrians (W 140A) to be mounted on Belisha Beacons

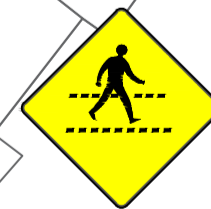

Directional sign to be provided with ramp ahead sign (W 130) mounted underneath



NOTES



Tipperary County Council  
Civic Offices, Clonmel | Civic Offices, Nenagh,  
Co. Tipperary



7 Ormonde Road,  
Kilkenny  
Tel: +353(0)567795800  
e-mail: info@roadplan.ie

No.	Revision	Date	By	Chk'd	App'd

Project Title: <b>NENAGH TMP - ONE WAY SYSTEM</b>			
Drawing Title: <b>Signs and Roadmarkings - Emmet Place / Banba Sq. / Kickham St. Junction</b>			
Drawn by:	FH	Sheet Size:	A1
Scale:	1:200	Date:	Mar '23
Designed:	AC	Checked:	GF
Approved:	DD	Revision:	-
Drawing Number:	21057-01-0008		

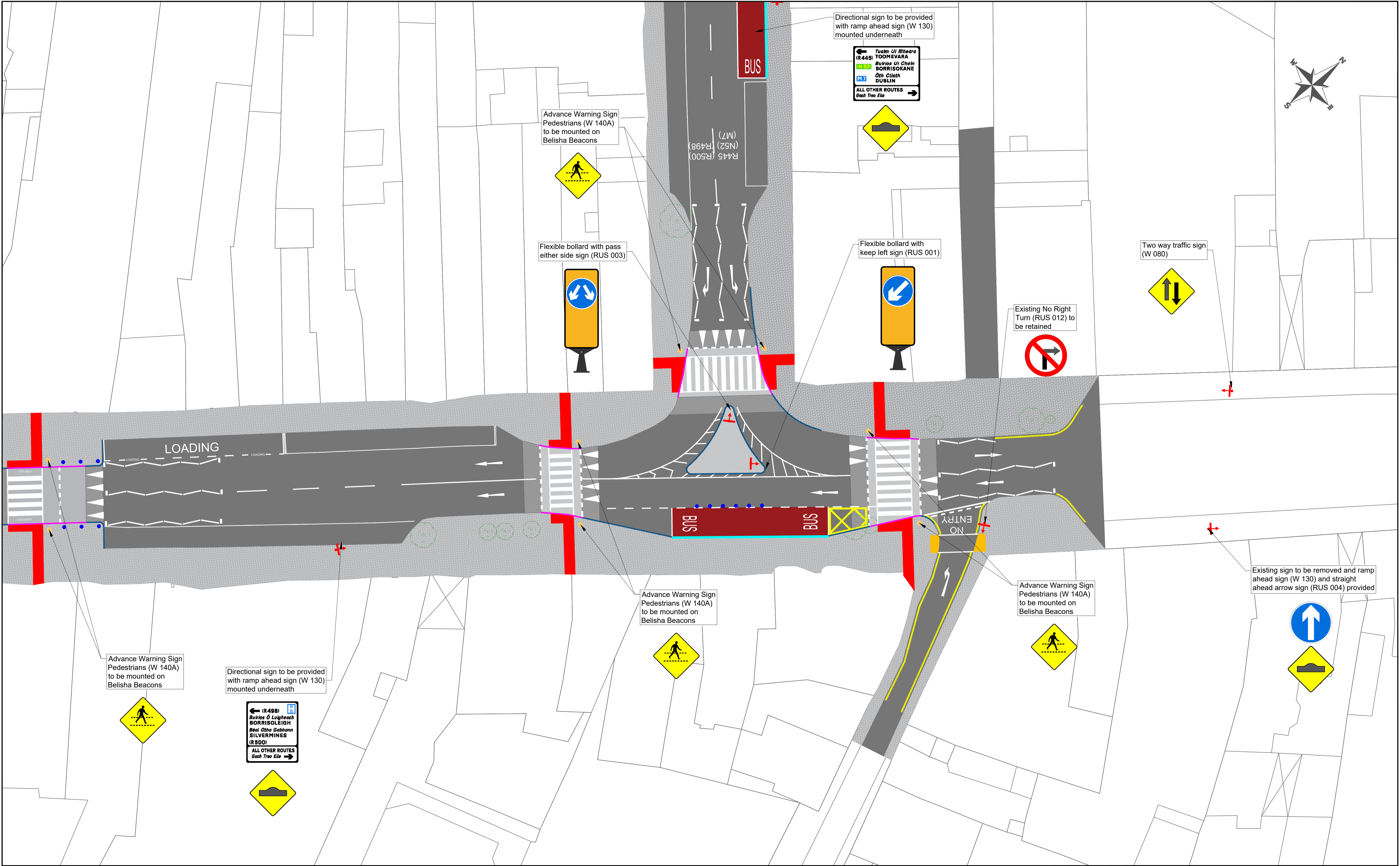

Advance Warning Sign Pedestrians (W 140A) to be mounted on Belisha Beacons

Directional sign to be provided with ramp ahead sign (W 130) mounted underneath

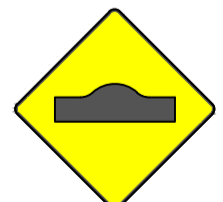

Advance Warning Sign Pedestrians (W 140A) to be mounted on Belisha Beacons



Flexible bollard with pass either side sign (RUS 003)

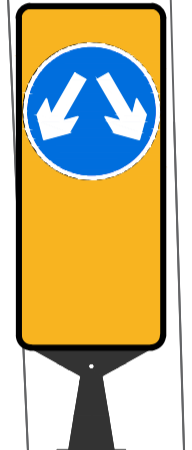

Directional sign to be provided with ramp ahead sign (W 130) mounted underneath

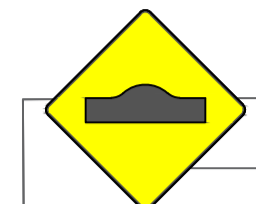

Flexible bollard with keep left sign (RUS 001)

Existing No Right Turn (RUS 012) to be retained



Two way traffic sign (W 080)

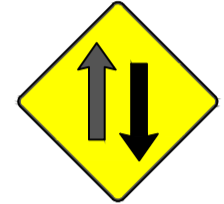

Advance Warning Sign Pedestrians (W 140A) to be mounted on Belisha Beacons



Advance Warning Sign Pedestrians (W 140A) to be mounted on Belisha Beacons



Existing sign to be removed and ramp ahead sign (W 130) and straight ahead arrow sign (RUS 004) provided

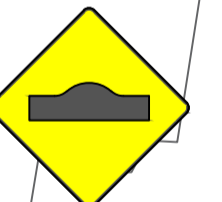
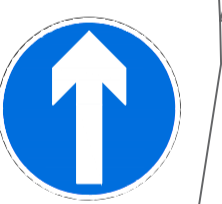

NOTES

No.	Revision	Date	By	Chk'd	App'd
Designed:	AC				
Checked:	GF				
Approved:	DD				

Project Title: **NENAGH TMP - ONE WAY SYSTEM**

Drawing Title: **Signs and Roadmarkings - Kickham St. / Pearse St. Junction**

Drawn by: FH Sheet Size: A1 Scale: 1:200 Date: Mar '23

Drawing Number: 21057-01-0009 Revision: -

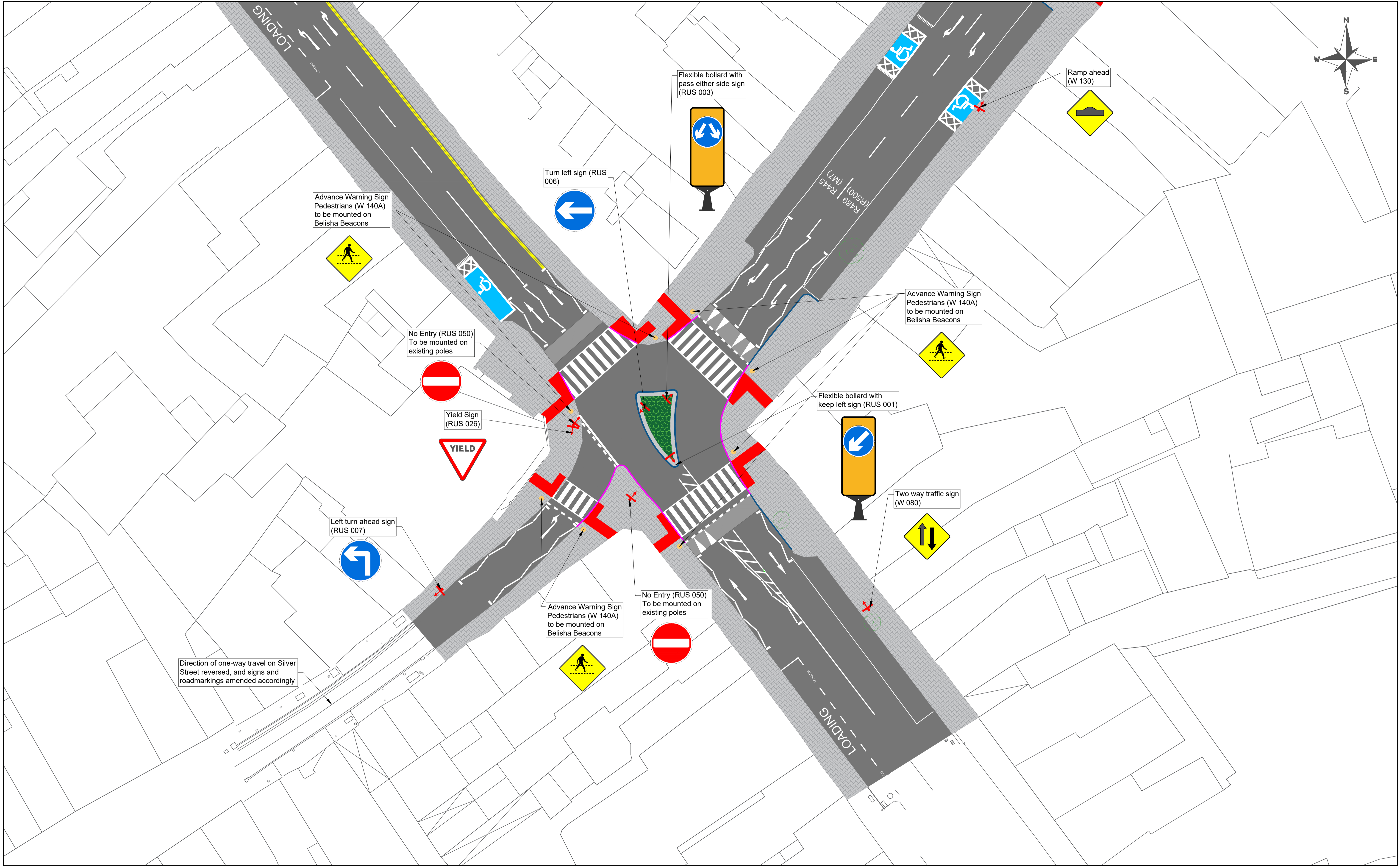

Direction of one-way travel on Silver Street reversed, and signs and roadmarkings amended accordingly

Advance Warning Sign Pedestrians (W 140A) to be mounted on Belisha Beacons

Turn left sign (RUS 006)

Flexible bollard with pass either side sign (RUS 003)

Ramp ahead (W 130)

No Entry (RUS 050) To be mounted on existing poles

Advance Warning Sign Pedestrians (W 140A) to be mounted on Belisha Beacons

Yield Sign (RUS 026)

Flexible bollard with keep left sign (RUS 001)

Left turn ahead sign (RUS 007)

Two way traffic sign (W 080)

Advance Warning Sign Pedestrians (W 140A) to be mounted on Belisha Beacons

No Entry (RUS 050) To be mounted on existing poles

**NOTES**



Tipperary County Council  
Civic Offices, Clonmel | Civic Offices, Nenagh,  
Co. Tipperary



7 Ormonde Road,  
Kilkenny  
Tel: +353(0)567795800  
e-mail: info@roadplan.ie

No.	Revision	Date	By	Chk'd	App'd

Project Title: <b>NENAGH TWP - ONE WAY SYSTEM</b>			
Drawing Title: <b>Signs and Roadmarkings - Silver St. / Mitchel St. Junction</b>			
Drawn by: FH	Sheet Size: A1	Scale: 1:200	Date: Mar '23
Drawing Number: 21057-01-0010		Revision: -	